

7

YDB40-11

Rated Impedance (Ω)	$8 \pm 15\%$
Rated (Max) Power (W)	0.15 (0.3)
Resonance Frequency (Hz)	$500 \pm 20\%$
Rated Freq. Range (Hz)	f.-3500
Sound Pressure Level (dB/1m, 1w)	82 ± 3
Weight (g)	5.2
Operating Temperature ($^{\circ}\text{C}$)	-10~+40

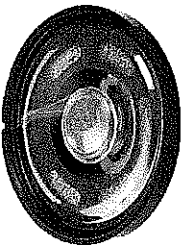
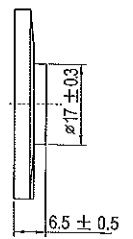
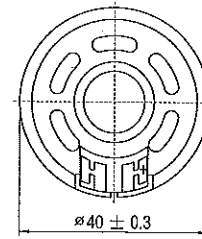
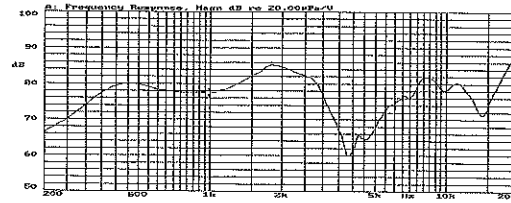

YDB40-11P

Rated Impedance (Ω)	$8 \pm 15\%$
Rated (Max) Power (W)	1 (1.5)
Resonance Frequency (Hz)	$500 \pm 20\%$
Rated Freq. Range (Hz)	f.-3500
Sound Pressure Level (dB/1m, 1w)	82 ± 3
Weight (g)	5.2
Operating Temperature ($^{\circ}\text{C}$)	-10~+40

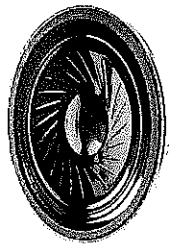
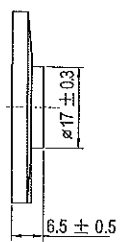
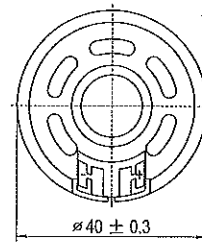
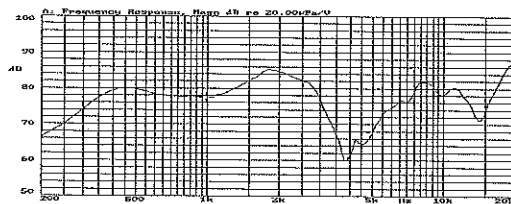

8

YDB40-12

Rated Impedance (Ω)	$8 \pm 15\%$
Rated (Max) Power (W)	0.2 (0.3)
Resonance Frequency (Hz)	$550 \pm 20\%$
Rated Freq. Range (Hz)	f.-3500
Sound Pressure Level (dB/1m, 1w)	82 ± 3
Weight (g)	10
Operating Temperature ($^{\circ}\text{C}$)	-10~+40

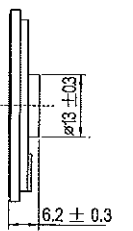
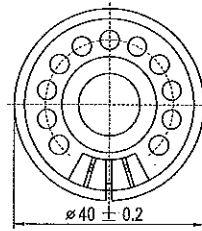
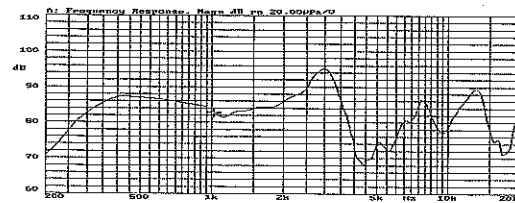

YDB40-12P

Rated Impedance (Ω)	$8 \pm 15\%$
Rated (Max) Power (W)	1 (1.2)
Resonance Frequency (Hz)	$550 \pm 20\%$
Rated Freq. Range (Hz)	f.-5000
Sound Pressure Level (dB/1m, 1w)	82 ± 3
Weight (g)	10
Operating Temperature ($^{\circ}\text{C}$)	-10~+40

