

Starter Button Switches

Q-10229

TYPE: **A2-5B**

SPECIFICATIONS

Contact Type	SPST
Rating	DC 24V, 10A
Contacts Resistance	10mΩ
Insulation Resistance	1000MΩ
Minimum Load	DC 500V
Dielectric Strengths	AC 1000V / 1 minute
Life Test	10 000 cycles

Cap Type

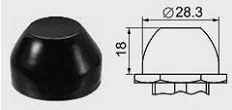

Waterproof

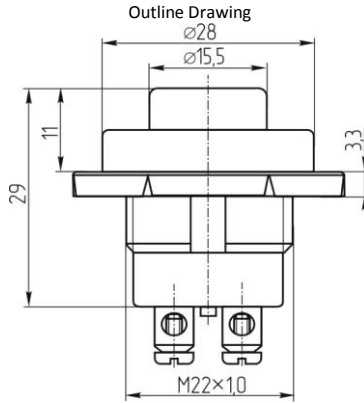

Mounting

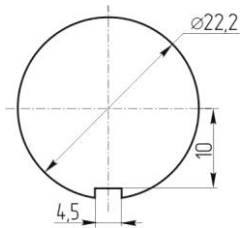

Circuitry



OFF - (ON)
2P SPST