

Slide Switch

Q-10038

TYPE: **SS-12D01**

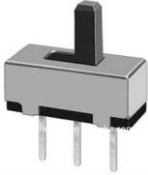

SPECIFICATIONS

Contact Type	SPDT
Pin Width	2.5mm
Rating	DC 50V, 0.3A
Contacts Resistance	30mΩ
Insulation Resistance	100MΩ
Minimum Load	DC 500V
Dielectric Strengths	AC 500V / 1 minute
Life Test	10 000 cycles/ minute
Material	Plastic & Metal

Outline Drawing

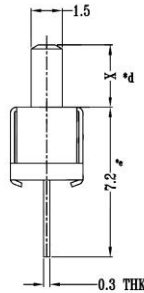
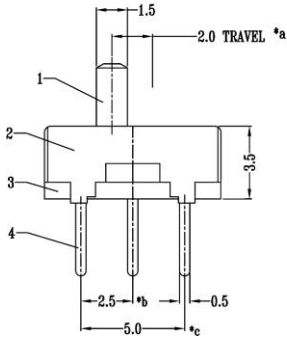
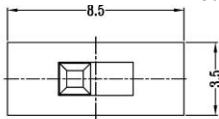

Mounting

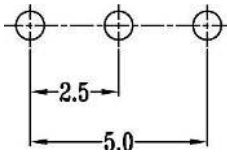

Circuitry

